

(Published in *The Journal Record* January 6, 2025.)
NOTICE OF HEARING

El presente aviso trata sobre una propuesta de cierre de servidumbre cerca de su propiedad. La agenda a tratar y el informe del personal se publicarán en el siguiente enlace: <https://okc.primegov.com/public/portal> . Llame al (405) 297-3533 si requiere información adicional.

CASE NUMBER: CE-1137

DATE OF HEARING: January 23, 2025

LEGAL DESCRIPTION: All of the 5-foot utility easement in Lot TEN (10) in Block FIFTY-FIVE (55) of SEMINOLE POINTE ADDITION SECTION 12 to the City of Oklahoma City, Oklahoma County, Oklahoma, according to the recorded plat in Book 62, Page 70.

NOTICE IS HEREBY GIVEN that **He Ping Chen and Rong Yong Mo** has filed an application with the Oklahoma City Planning Department to close the easement(s) indicated on the reverse side of this notice.

Your property is not included within the area proposed to be closed. This notice is being provided to you because you own property nearby.

- You are not required to attend the hearing, but if you wish to you may. You may also have someone appear on your behalf.

The Planning Commission will hold a public hearing on the date shown above. Brief written materials, graphics, maps, pictures, etc. may be presented to the Commission to illustrate a point regarding a case. Materials in support or opposition of a pending application should be submitted to City staff at the email or mailing address below by **noon on Friday January 17, 2025**, to be copied and delivered to the Commission members.

Following the hearing, the Planning Commission forwards its recommendations to the City Council where an ordinance to close the easement(s) is scheduled for a final public hearing. You will receive notice by mail of the final Council hearing from the City Clerk.

LOCATION OF PUBLIC HEARING

A PUBLIC HEARING will be held by the Oklahoma City Planning Commission at 1:30 p.m. on Thursday, January 23, 2025, in the Council Chamber, Third Floor, Municipal Building, 200 North Walker Avenue, Oklahoma City, Oklahoma.

The agenda and staff report for this meeting will be posted at following link:

<https://okc.primegov.com/public/portal>

Please conduct your business with us by phone or email.

Case No: CE-1137

Applicant: He Ping Chen and Rong Yong Mo

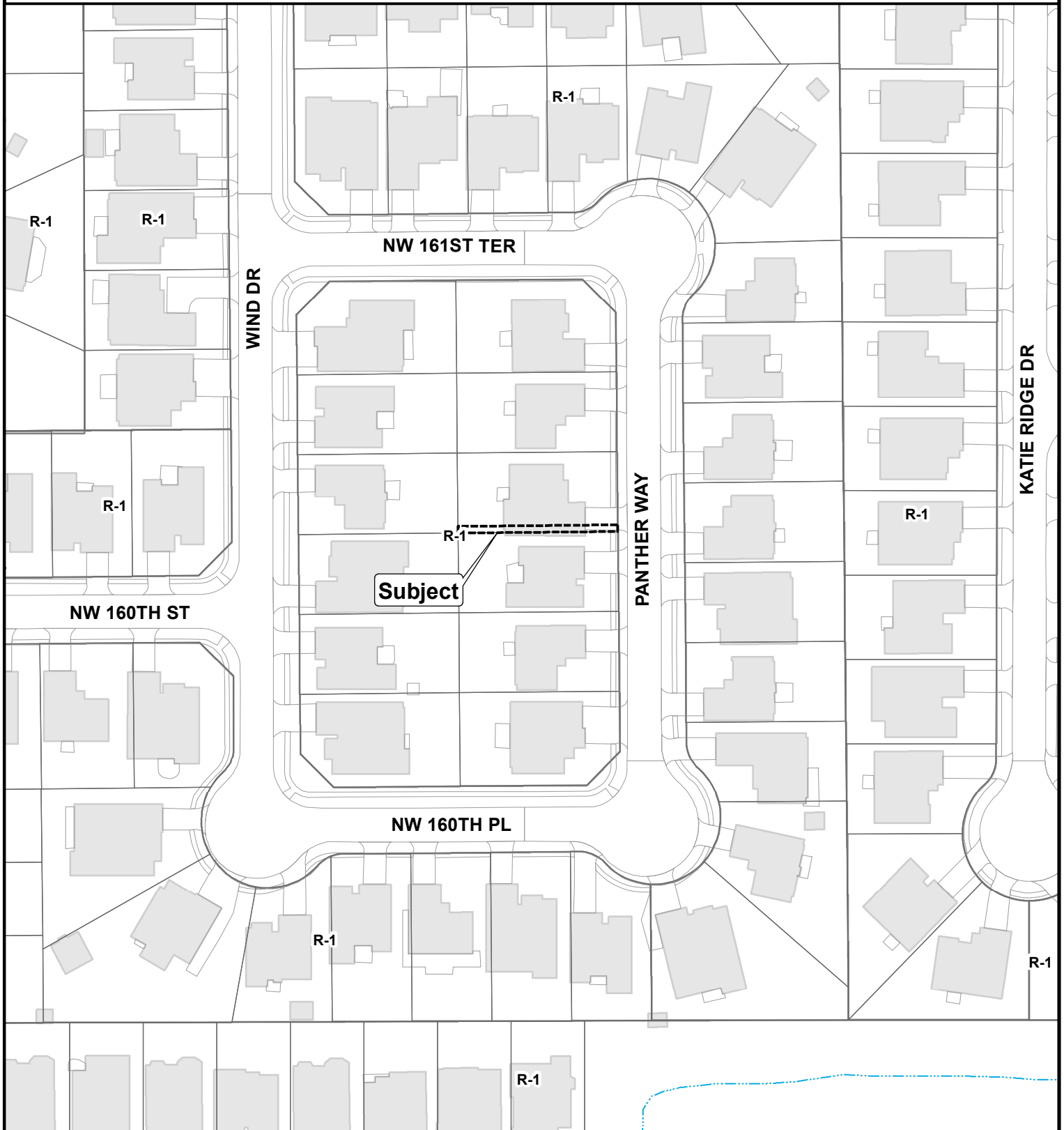

Note: "Subject" is located approximately 1,688' South of NW 164th St. & 1,324' West of N. Pennsylvania Ave.



The City of
OKLAHOMA CITY

Application for Closing Public Way or Easement



0 50 100
Feet